

# BUILDING DOUBLE WIDE TRESTLE BENTS

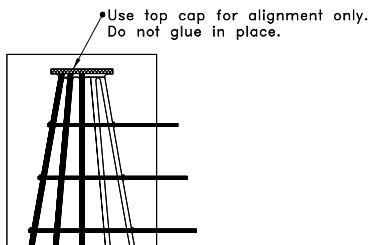

MINIMUM TRACK CENTER DISTANCE NMRA RECOMMENDATION - 0 SCALE	
STRAIGHT, PARALLEL TRACK	
STANDARD GAUGE	3-1/4"
NARROW GAUGE	2-3/4"
33" RADIUS	
STANDARD GAUGE	4"
NARROW GAUGE	3-5/8"
ADDITIONAL RADII SPECIFIED IN NMRA STANDARDS, SHEET NO. S-8, AUGUST, 1982.	

1 Build two partial bent assemblies as shown.

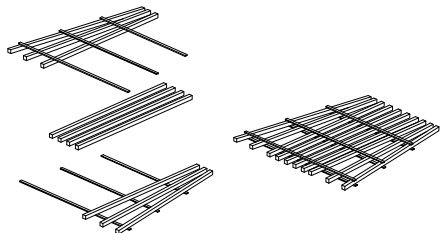

2 Flip over one of the partial bents and assemble with three or four additional vertical supports. Use the full size drawing above. Adjust the spacing if required for curved trestle.

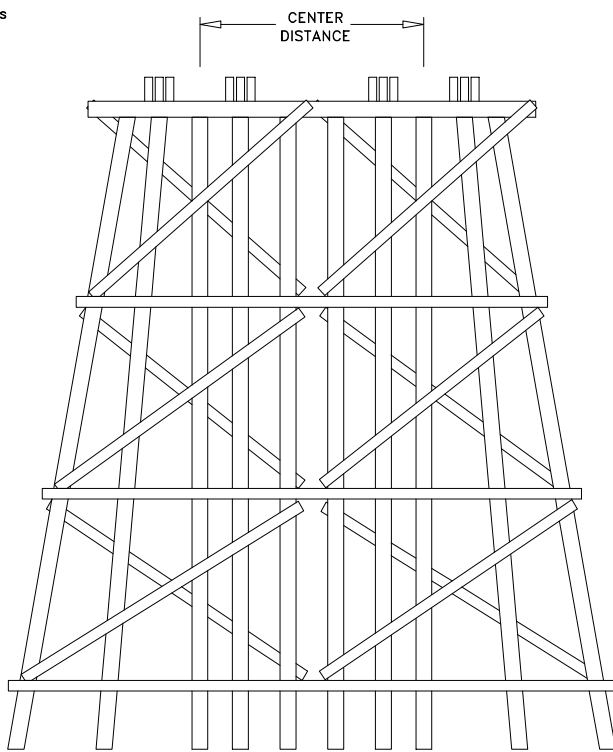

DOUBLE TRACK TRESTLE - STANDARD GAUGE  
FULL SIZE - 0 SCALE

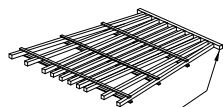

3 Add trestle cap that spans entire width.

## SOME OPTIONS FOR BRACING

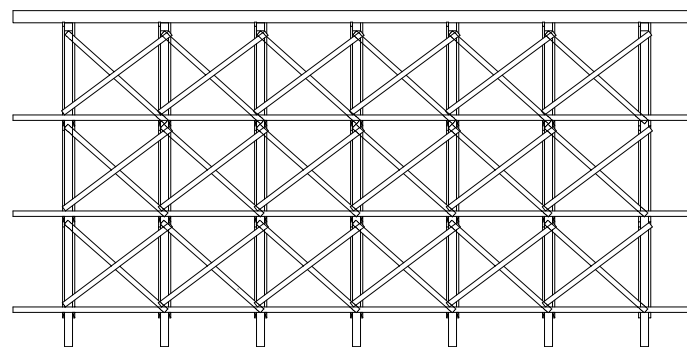

3" TO 4-1/2"  
(TYPICAL PROTOTYPE: 12' TO 18')  
FULL LATTICE DIAGONAL SIDE BRACING  
SHOWN HALF SIZE - 0 SCALE

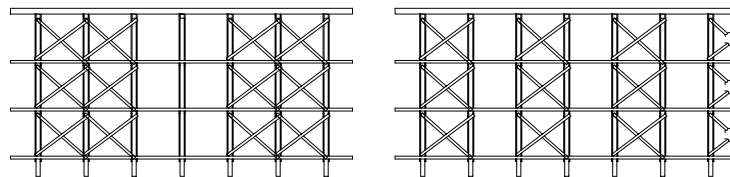

ALTERNATE DIAGONAL SIDE BRACING  
SHOWN 1/4 SIZE - 0 SCALE

DRAWING SIZE	"0" SCALE TRESTLE
SHEET 2 OF 2	<b>Black Bear Construction Co.</b> PO Box 26911 (512) 467-8400 Austin, Texas 78755-0911 FAX: (512) 458-8765
	DRAWING SCALE 1:1